

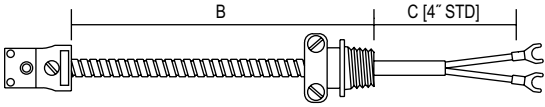

THERMOCOUPLE ACCESSORIES

EXTENSION CABLES



MODEL CODING

Fill in the appropriate numbers or letters to specify the extension cable of your choice. Fill in all boxes. If an item or dimension does not apply, fill those boxes with zeros '0'.

EC-	<input type="text"/>	<input type="text"/>	<input type="text"/>	<input type="text"/>	<input type="text"/>	<input type="text"/>	<input type="text"/>	<input type="text"/>	<input type="text"/>	<input type="text"/>	<input type="text"/>	<input type="text"/>	<input type="text"/>	<input type="text"/>
	B				C (TERM. #1)		C (TERM. #2)							
	IN FEET				IN INCHES		IN INCHES							
SENSOR TYPE J: T/C K: T/C E: T/C T: T/C 2: RTD 2-wire 3: RTD 3-wire	EXTENSION TYPE 0: No extension 1: Fiberglass insulation 3: Stainless steel overbraid 4: FEP insulation 5: Stainless steel flex hose 6: FEP over SS flex hose					TERMINAL #1 0: Stripped ends 1: Lugs 2: Lugs with BX 3: Standard plug 4: Standard jack 6: Mini plug 7: Mini jack 9: Fastabs A: Fastabs with BX			TERMINAL #2 0: Stripped ends 1: Lugs 2: Lugs with BX 3: Standard plug 4: Standard jack 6: Mini plug 7: Mini jack 9: Fastabs A: Fastabs with BX			ELEMENTS 1: Single 2: Dual		

COMPRESSION FITTINGS

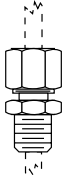

MODEL CHART							
Model	Type OD	Thread Size	Material	Model	Type OD	Thread Size	Material
144-0012	1/8"	1/8-27 NPT	Brass	144-0014	1/4"	1/4-18 NPT	Brass
144-0009	3/16"	1/8-27 NPT	Brass	144-0024	1/4"	1/8-27 NPT	SS
144-0022	3/16"	1/8-27 NPT	SS	144-0037	.260 - .275"	1/4-18 NPT	FEP

PIPE ADAPTERS

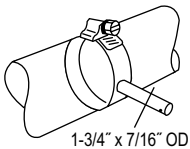

MODEL CHART					
Model	Fits Pipe Diameters	Model	Fits Pipe Diameters	Model	Fits Pipe Diameters
1568-0007	1/2" to 7/8"	1568-0020	6-1/4" to 6-3/4"	1568-0025	17-3/4" to 18-1/4"
1568-0008	7/8" to 1-1/2"	1568-0021	7-3/4" to 8-1/4"	1568-0027	19-3/4" to 20-1/4"
1568-0009	1-5/16" to 2-1/4"	1568-0022	9-3/4" to 10-1/4"	1568-0028	23-3/4" to 24-1/4"
1568-0011	2-1/4" to 3-5/16"	1568-0023	11-3/4" to 12-1/4"	1568-0029	29-3/4" to 30-1/4"
1568-0013	4-5/16" to 5-1/4"	1568-0024	15-3/4" to 16-1/4"		

BAYONET ADAPTERS

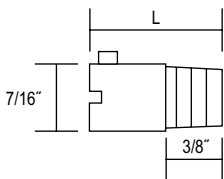

MODEL CHART		
Model	L	Thread Size
1568-0001	7/8"	1/8-27 UNF
1568-0002	7/8"	3/8-24 UNF
1568-0003	1-3/8"	1/8-27 UNF
1568-0004	1-3/8"	3/8-24 UNF
1568-0005	2-1/2"	1/8-27 UNF
1568-0006	2-1/2"	3/8-24 UNF
1568-0016	2-1/2"	10 x 1.5 mm

TRANSITION ADAPTERS

These adapters convert the miniature plug on the end of the coiled cable on the Master Probe Handle to a standard lug. Simply plug the cord into the adaptor.

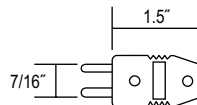

MODEL CHART	
Model	Type
481-0127	K
481-0128	T

USA: California Proposition 65
WARNING: This product can expose you to chemicals including Lead, which is known to the State of California to cause cancer and birth defects or other reproductive harm. For more information go to www.P65Warnings.ca.gov.